

1 NORTH ELEVATION  
F400 SCALE: 1:200

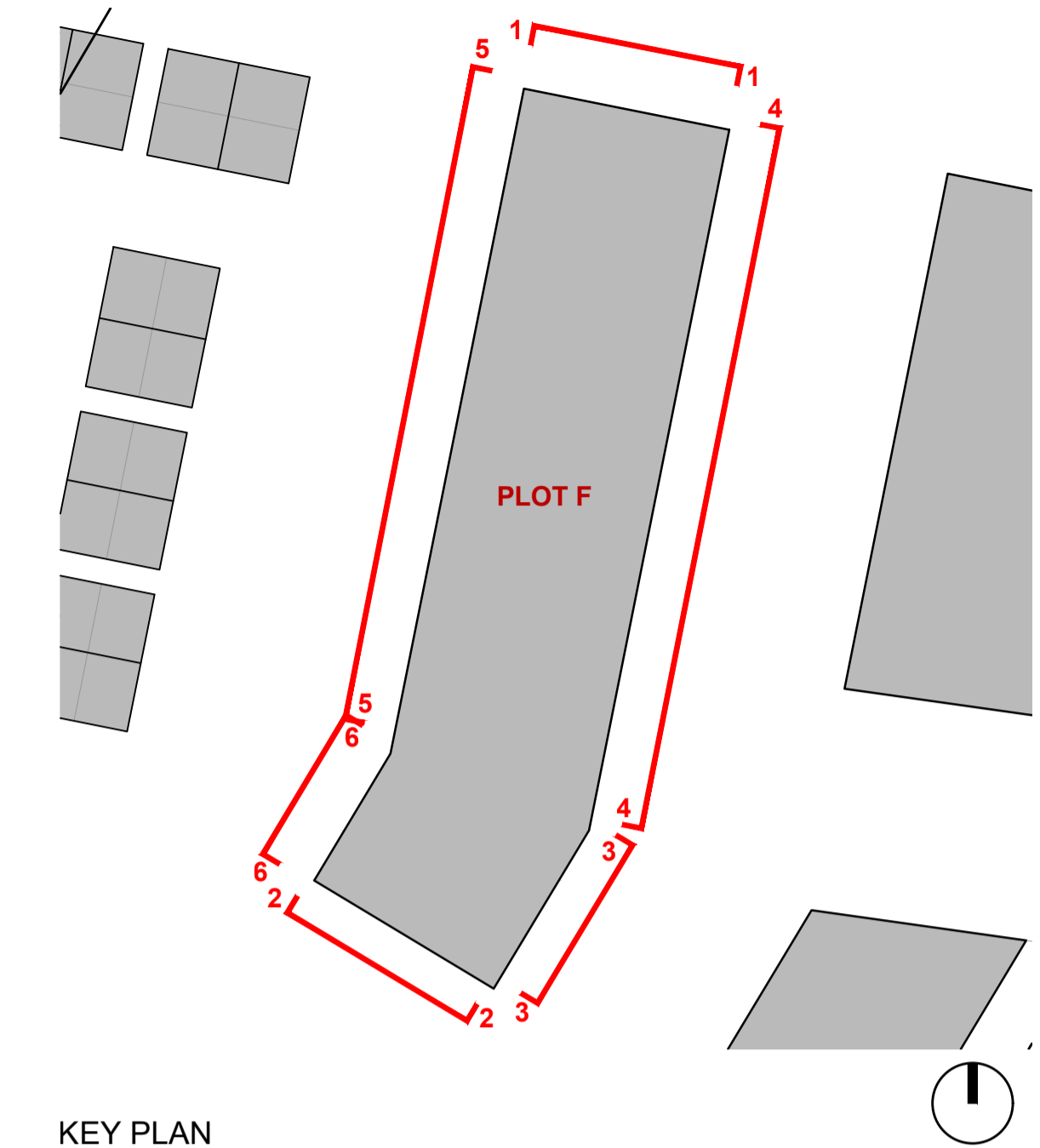

2 SOUTH ELEVATION  
F400 SCALE: 1:200



KEY PLAN



3 SOUTH EAST ELEVATION  
F400 SCALE: 1:200

4 EAST ELEVATION  
F400 SCALE: 1:200



5 WEST ELEVATION  
F400 SCALE: 1:200

6 NORTH WEST ELEVATION  
F400 SCALE: 1:200

NOTES / LEGEND

- |   |   |
|---|---|
| (1A) DARK TONED BRICKWORK                                 | (07) METAL GATE TO SELECTED COLOUR FINISH   |
| (1B) MID TONED BRICKWORK                                  | (08) METAL RAILING TO SELECTED COLOUR FINISH  |
| (1C) LIGHT TONED BRICKWORK                                | (09) PERFORATED METAL BALUSTRADE/SCREEN TO SELECTED COLOUR FINISH                     |
| (02) PATTERNED BRICK TO MATCH ADJACENT BRICK COLOUR       | (10) METAL DOOR TO SELECTED COLOUR FINISH   |
| (03) SELF FINISH RENDER TO SELECTED COLOUR FINISH         | (11) FRAMED GLAZED DOOR TO SELECTED COLOUR FINISH                                     |
| (04) FRAMED DOUBLE GLAZED WINDOWS UNIT TO SELECTED COLOUR | (12) SINGLE GLAZED BALCONY WIND SCREEN  |
| (05) METAL CLADDING PANEL TO SELECTED COLOUR FINISH       | (13) PERFORATED METAL MESH WITH STAGGERED VERTICAL MULLIONS TO SELECTED COLOUR FINISH |
| (06) METAL LOUVRED ACCESS DOOR TO SELECTED COLOUR FINISH  | (14) METAL OPEN TREAD STAIR TO SELECTED COLOUR FINISH                                 |

GENERAL NOTES:  
 - DRAWING TO BE READ IN CONJUNCTION WITH ALL OTHER DRAWINGS AND REPORTS PREPARED BY MOLA AND DESIGN TEAM MEMBERS.  
 - THE DIMENSION / BUILDING HEIGHT IS TAKEN FROM A DATUM AT THE HIGH POINT ON THE STREET. THIS IS WITHIN THE MAXIMUM PERMISSIBLE BUILDING HEIGHT OF 18M (VILLAGE CENTRE) AND 16M (RES 2 / RES 3) IN ACCORDANCE WITH SECTION 2.9 AND TABLE 2.11 OF THE CHERRYWOOD SDZ.  
 - REFER TO ARCHITECT'S ELEVATION DRAWINGS FOR DETAILED SCOPE OF PROPOSED MATERIALS.  
 - REFER TO ARCHITECT'S DESIGN REPORT FOR FURTHER INFORMATION ON PROPOSED MATERIALS.  
 - LANDSCAPING SHOWN IS INDICATIVE. REFER TO LANDSCAPE ARCHITECT'S DRAWINGS FOR DETAILED INFORMATION.

Key Plan:

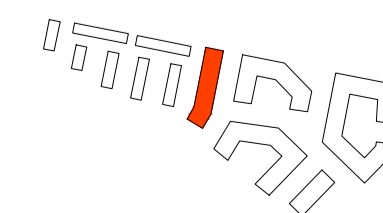

Rev.	Date	Description	By
P-01	25/03/2022	ISSUED FOR PLANNING	MOLA

**MOLA** 2 Donnybrook Road, Donnybrook, Dublin 4, Ireland. Telephone +353 1 218 3900 www.molaarchitecture.com

Notes: Do not scale. Use figured dimensions only. This drawing is to be read in conjunction with all relevant specifications and drawings. All dimensions to be checked on site. In the event of any discrepancies between drawings, the contractor is to inform the Architect immediately.

© COPYRIGHT This drawing or design may not be reproduced without permission.

Stage: **PLANNING**

Client: 1 CARRICKMINES LAND LIMITED

Project: PRIORSLAND CHERRYWOOD SHD

Drawing: PLOT F: PROPOSED EXTERNAL ELEVATIONS

Date: MARCH 2022 Scale: 1:200 @A1 Status: 18029

Drawing No.: PLD18-MOLA-F-XX-DR-A-40-F400 Status: Revision: P-01